

INSTALLATION INSTRUCTIONS

DESCRIPTION: Rear Carrier
PART NUMBER: BW3-F48D0-V0
MODEL: '21+ Ténéré 700



⚠ WARNING

Please read and understand these instructions completely before installation to avoid possible injury, or damage to the accessory or vehicle.

NOTICE:

Installation of this kit requires a torque wrench and should be performed by an authorized Yamaha dealer or a qualified mechanic.

WARRANTY INFORMATION:

In the United States, see your Yamaha dealer for a copy of the Yamaha Genuine Parts and Accessories Limited Warranty.

DEALER OR INSTALLER:

These instructions contain important information for future reference and *must* be given to the customer.

PARTS LIST:

No.	Part Number	Description	Qty
--	BW3-F48D0-V0	Rear Carrier Kit	-
①	-	Rear Carrier	1
②	-	Passenger Foot Peg Brackets left	1
③	-	Passenger Foot Peg Brackets right	1
④	-	M8X45mm Socket Head Bolt	4
⑤	-	M8x70mm Socket Head Bolt	4
⑥	-	M8 Washer	4
⑦	-	Spacer 36.5mm	2
⑧	-	M6 Nylon Locking Nut	4
⑨	-	M6x16mm Hex Flanged Bolt	4

* Part supplied with kit only and not available separately.

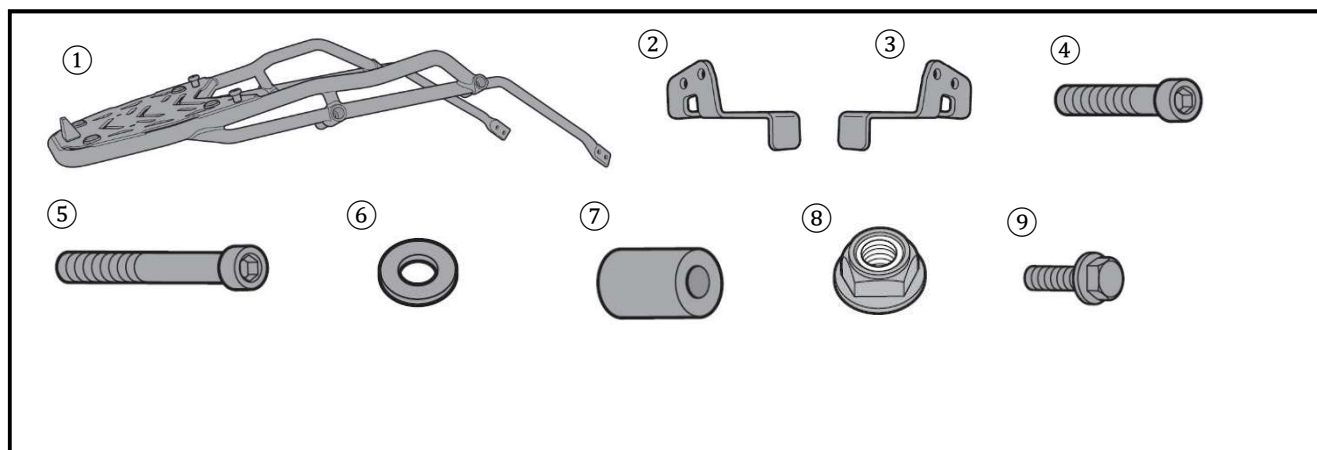
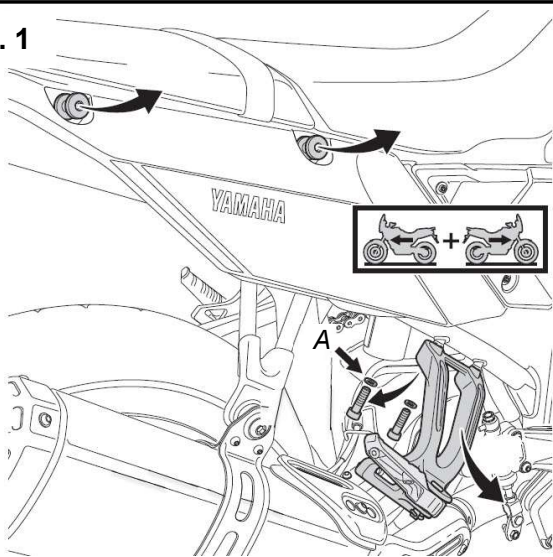
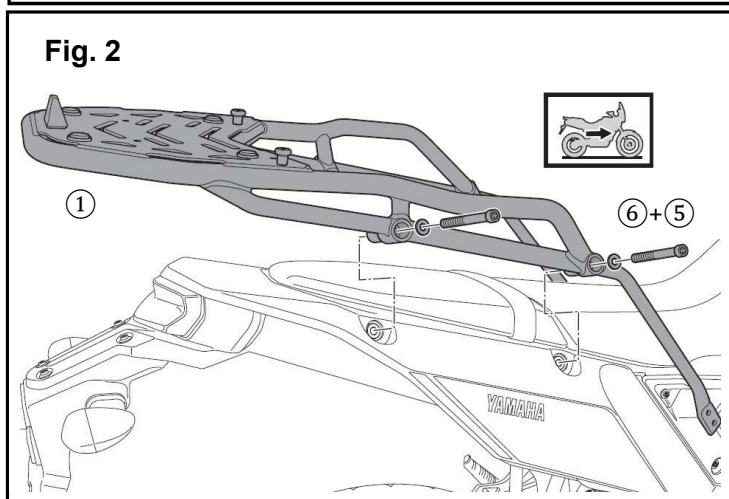
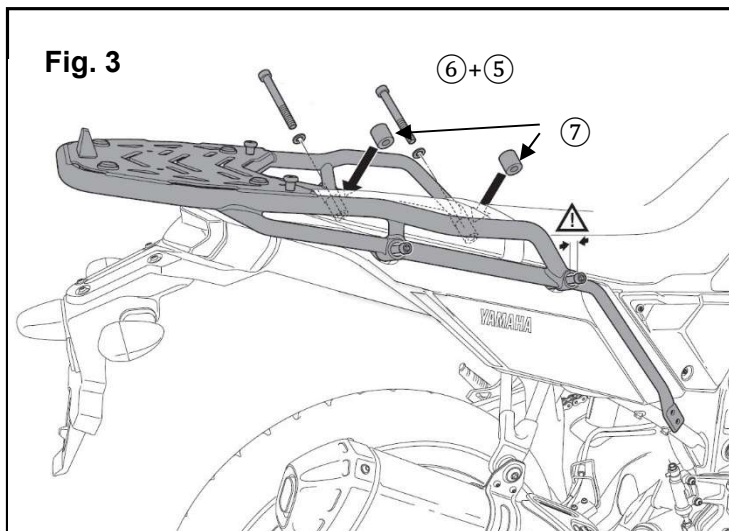
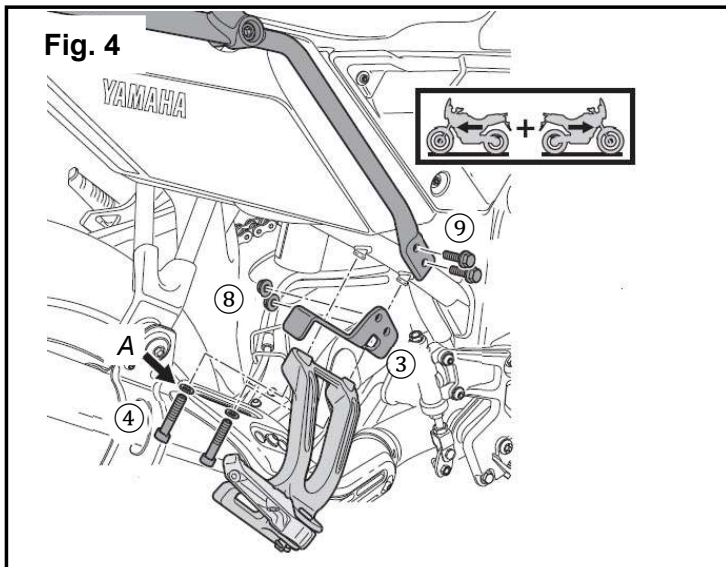

Fig. 1**Fig. 2****Fig. 3****PREPARATION:**

- Place the vehicle on a secure and level surface.
- Clean the mounting surfaces before beginning installation.

INSTALLATION:

1. Remove the tie down posts on the tail section. They will not be reused. (Fig. 1)
2. Remove the passenger foot pegs from both sides of the motorcycle. Retain the washers. The mounting bolts are not reused. (Fig. 1)
3. Align the ① Rear Carrier over the tail section and thread two ⑤ M8x70 Socket Head bolts with ⑥ M8 Washers into the right side of the tail section. Leave loose for adjustment. (Fig. 2)
4. Insert the ⑦ Spacers under the ① Rear Carrier mounting holes on the left side of the tail section.
5. Thread two ⑤ M8x70 Socket Head bolts with ⑥ M8 Washers into the mounting holes in the tail section. (Fig.3)
6. Tighten all four ⑤ M8x70 Socket Head bolts to 20Nm (2.0 kg-m or 14.7 lb-ft).
7. Install the right passenger foot peg with the ③ Passenger Foot Peg Bracket placed between the frame and foot peg. Use two ④ M8x45 Socket Head bolts with the stock washers. Tighten to 20 Nm (2.0 kg-m or 14.7 lb-ft). (Fig. 4)
8. Place the ① Rear Carrier over the ③ Passenger Foot Peg bracket and insert two ⑨ M6x16mm Hex Flanged Bolts through the ① Rear Carrier and ③ Passenger Foot Peg Bracket. Thread two ⑧ M6 Nylon Locking Nuts on to the ⑨ M6x16mm Hex Flanged Bolts and tighten to 10 Nm (1.0 kg-m or 7.3 lb-ft) (Fig. 4)
9. Repeat steps 7 and 8 for the left side of the motorcycle using the ② Passenger Foot Peg Bracket.



MAINTENANCE:

Periodically, check torque on all hardware. If loose hardware is found, re-torque to specification.

CARE AND CLEANING:

Clean painted metal parts with a clean soft cloth and mild soap and water solution. Rinse and dry.

CUSTOMER SERVICE:

For further information see your Yamaha dealer.

ESTIMATED TIME TO INSTALL: 0.5 HRS.